

**LEGEND**

**TREE PROTECTION FENCING & EXCLUSION ZONE**

All fencing shall be installed prior to any plant activity on site whatsoever, including: demolition, utility installation, groundworks, and soil stripping

Once erected, all TPF will be regarded as sacrosanct, and will not be removed or altered without prior recommendation by the project arboriculturist and approval of the local planning authority. The TPF is suitable for areas of high intensity development, and shall comprise of interlocking weld-mesh panels, well braced to resist impacts by attachment to a scaffold framework that is set firmly into the ground. Should any alternative method of barrier construction be proposed, consultation with the project arboriculturist will be obtained to clarify the efficacy of the revised design prior to informing the local planning authority and obtaining their consent. Once the exclusion zone has been protected by barriers and/or ground protection, construction work can commence. All weather notices may be erected on the barriers.

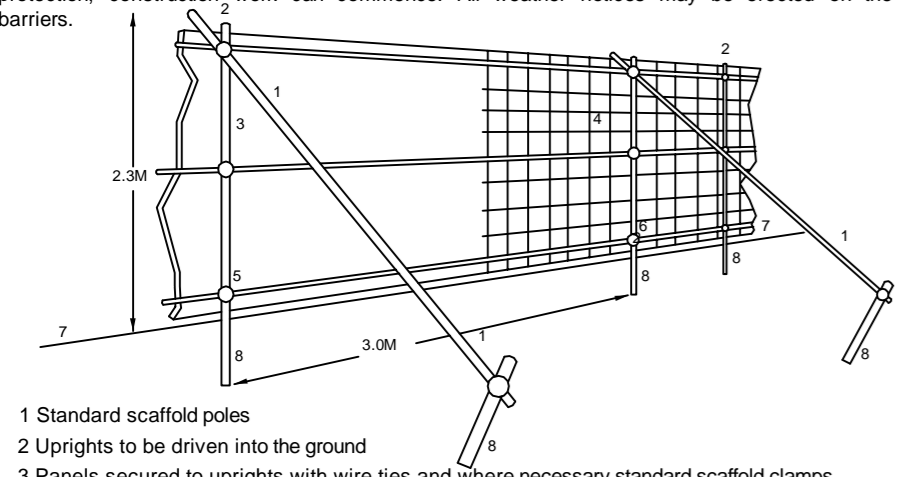

- 1 Standard scaffold poles
- 2 Uprights to be driven into the ground
- 3 Panels secured to uprights with wire ties and where necessary standard scaffold clamps
- 4 Weldmesh wired to the uprights and horizontals
- 5 Standard clamps
- 6 Wire twisted and secured on inside face of fencing to avoid easy dismantling
- 7 Ground level
- 8 Approx. 0.6m driven into ground

**SECONDARY POSITION OF FENCING**

The fencing is to be moved to this location upon installation of the no-dig surface to protect the remaining soft ground.

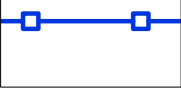

**NO-DIG SURFACE AREA**

The area of hardsurface is to be laid above the existing ground level, including retention of the existing hard surface. Surface to be porous tarmac (TarmacDry or similar) to approved details and specifications.

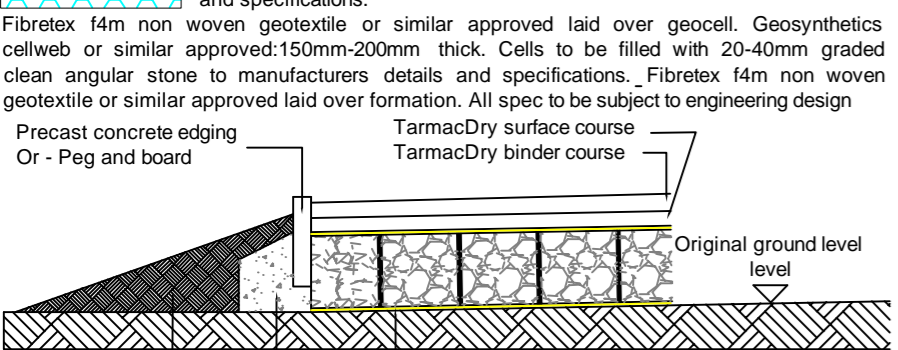

Fibretex 14m non woven geotextile or similar approved laid over geocell. Geosynthetics cellweb or similar approved:150mm-200mm thick. Cells to be filled with 20-40mm graded clean angular stone to manufacturers details and specifications. Fibretex 14m non woven geotextile or similar approved laid over formation. All spec to be subject to engineering design

**ROOT PROTECTION AREAS**



**RESTRICTIONS WITHIN TREE PROTECTION AREAS**

- Inside the exclusion area of the fencing, the following shall apply:
- No mechanical excavation whatsoever
  - No excavation by any other means without arboricultural site supervision
  - No hand digging without a written method statement having first been approved by the project arboriculturist.
  - No lowering of levels for any purpose (except removal of grass sward using hand tools)
  - No storage of plant or materials
  - No storage or handling of any chemical including cement washings
  - No vehicular access
  - No fire lighting
- In addition to the above, further precautions are necessary adjacent to trees:
- No substances injurious to tree health, including fuels, oil, bitumen, cement (including cement washings), builders sand, concrete mixing and other chemicals shall be stored or used within or directly adjacent to the protection areas of retained trees
  - No fire shall be lit such that flames come within 5m of tree foliage.

**PHASING & MONITORING OF DEVELOPMENT**

- The arboricultural protection on this site must be carried out in the following order:  
**Entire construction phase subject to monthly site monitoring visits from project arboriculturist.**
1. Tree removal and access facilitation pruning
  2. Accurate erection of tree protection fencing.
  3. **Site meeting with project arboriculturist, Local Authority Tree Officer, site manager and groundworkers.**
  4. Site accessible to construction/demolition traffic
  5. Demolition
  6. Construction
  7. Removal of tree protection fencing. To be carried out only after agreement with Council and project arboriculturist.
  8. Remedial tree surgery
  9. Final sign-off from project arboriculturist
- The above phasing must not be changed without approval from the project arboriculturist and agreement with the Council.

**TO BE READ IN CONJUNCTION WITH METHOD STATEMENT PRI17211ams**

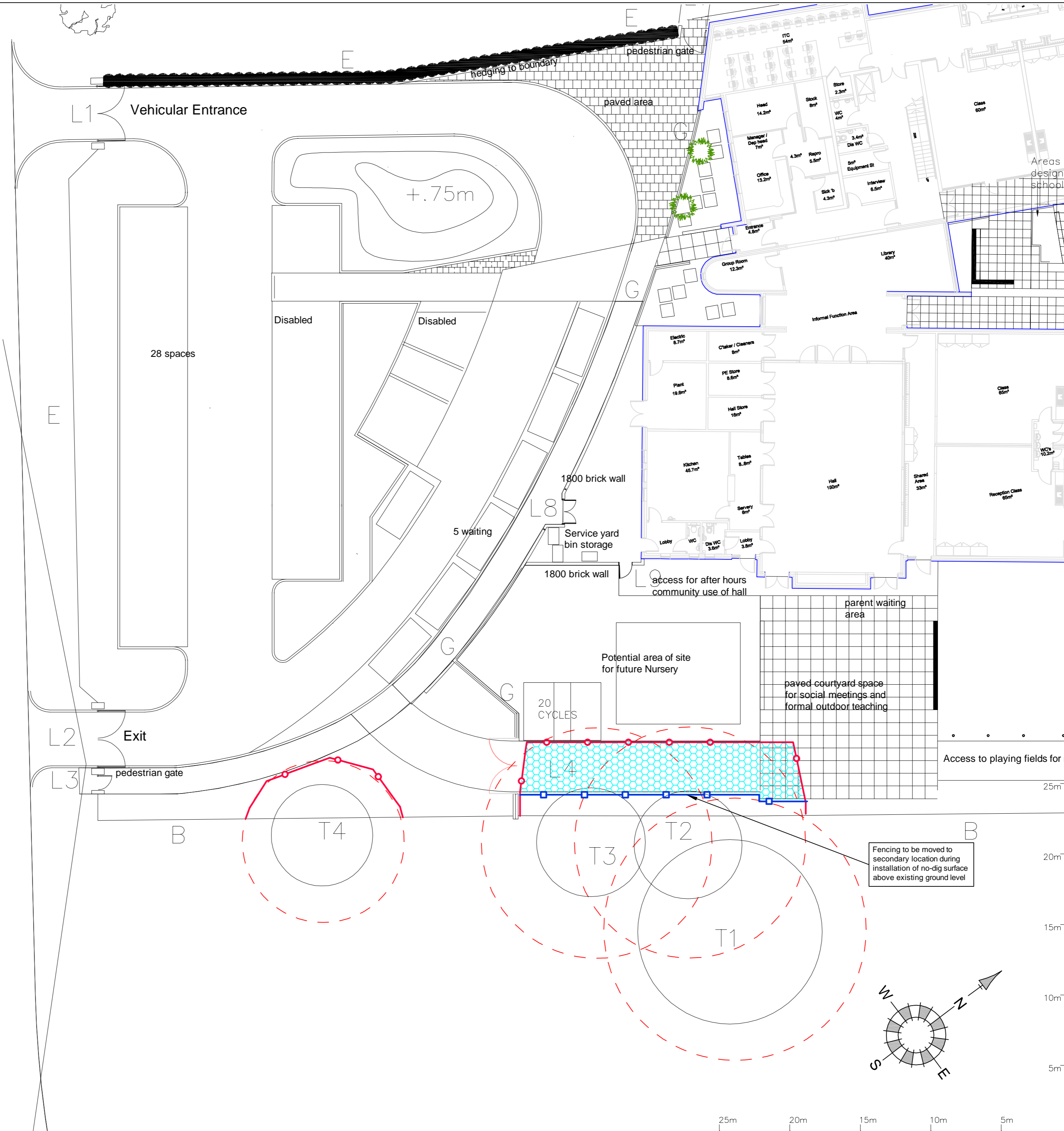

**ST PETER'S SCHOOL QUAKERS WALK, DEVISES TREE PROTECTION PLAN**

**ACD ARBORICULTURE**  
 Consultancy  
 Project Management  
 Development & Planning

TANNERS, CAXTON COURT, LOWER ROAD, HASLEMERE SURREY, GU27 2PE TEL: 01483 425714 FAX 01428 641090

Copyright of ACD Arboriculture. All rights described in Chapter IV of the Copyright, Designs and Patents Act 1988 have been generally asserted. © 22/12/2009. Copyright of this plan remains with ACD Arboriculture until all fees are paid in full. CLIENT

**THE GENESIS DESIGN STUDIO**

JOB TITLE  
**ST PETER'S SCHOOL QUAKERS WALK, DEVISES TREE PROTECTION PLAN**

DWG TITLE  
**PRI17211-03**

DWG No. **PRI17211-03**

SCALE **1:200@A2** DATE **DEC 2009**

DRAWN BY **MW** CHECKED BY

REV	DATE	DETAILS	DRAWN